

Rotary Modules

Overview

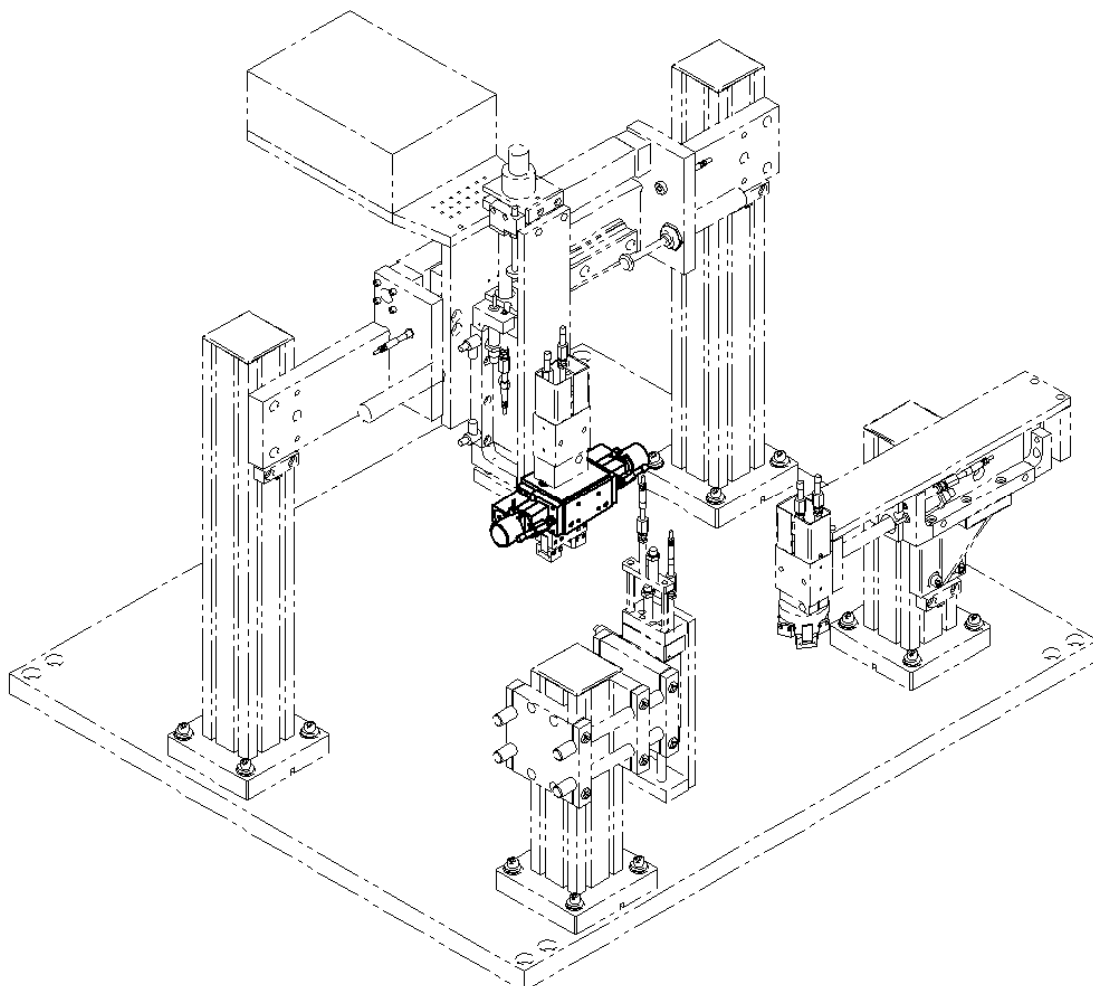

Rotary Module LR 2180

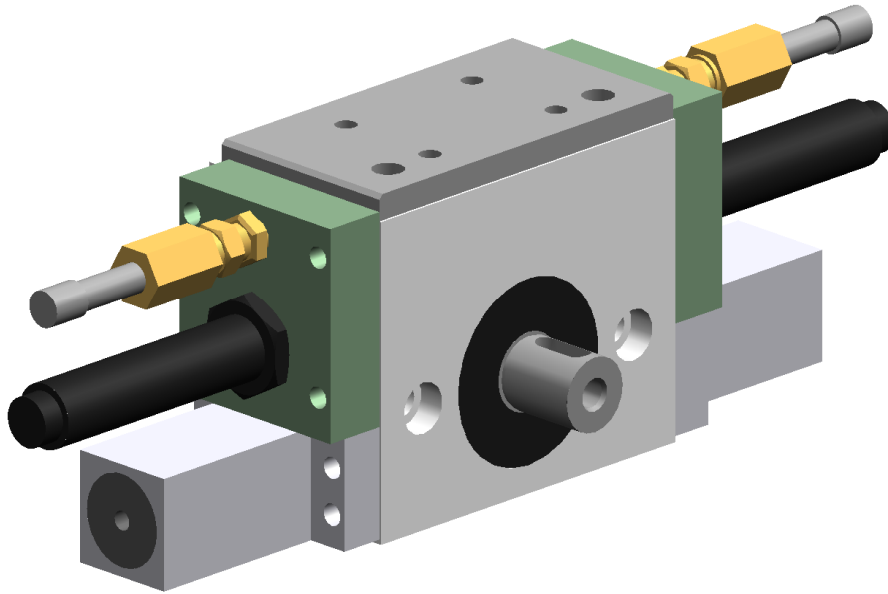

If your material handling needs call for rotary motion, look no further than the Lanco rotary module LR.

The LR series is engineered for complete compatibility with all Lanco handling system modules using the standard 60 mm (2.36 in) bolt pattern with counterbore for the exclusive Lanco locating ring.

Infinitely adjustable standard rotation ranges from zero to 185 degrees.

The optional mounting flange offers further compatibility with handling system modules with its standard 60 mm bolt pattern.

Precision ball bearings and end-of-stroke hydraulic shock absorbers insure smooth motion. Reliability and durability is guaranteed through the use of quality components and precision CNC machining on all Lanco handling system modules.

Handling System	
Model	LR 2180
Art.-No.	31-0050
Maximum Angular Rotation	0 ... 185°
Weight	1.4 kg (3.1 lbs)
Maximum Load	10 kg (22.0 lb)
Torque @ 6 bar (90 psig)	1.6 Nm (1.2 ft-lbs)
Repeatability	± 5'
Ports (P)	M5
Operating Medium	Clean, Dry Compressed Air – 120 psig max
Mounting Positions	Unlimited
Color	Gold/Bronze Anodize

Rotary Module LR 2180 Y

With 1 Intermediate Stop

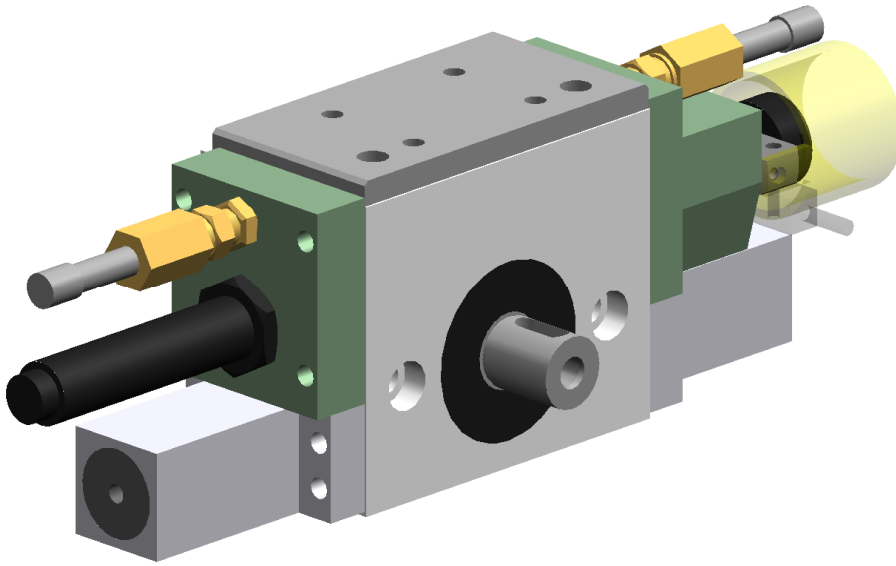

If your material handling needs call for rotary motion, look no further than the Lanco rotary module LR.

The LR series is engineered for complete compatibility with all Lanco handling system modules using the standard 60 mm (2.36 in) bolt pattern with counterbore for the exclusive Lanco locating ring.

Infinitely adjustable standard rotation ranges from zero to 185 degrees.

Design flexibility is further enhanced with an optional intermediate stop, giving an additional stop position between zero and 90 degrees.

The optional mounting flange offers further compatibility with handling system modules with its standard 60 mm bolt pattern.

Precision ball bearings and end-of-stroke hydraulic shock absorbers insure smooth motion. Reliability and durability is guaranteed through the use of quality components and precision CNC machining on all Lanco handling system modules.

Handling System	
Model	LR 2180 Y
Art.-No.	31-0051
Maximum Angular Rotation	0 ... 185°
Weight	1.5 kg (3.3 lbs)
Maximum Load	10 kg (22.0 lbs)
Torque @ 6 bar (90 psig)	1.6 Nm (1.2 ft-lbs)
Repeatability	± 5'
Ports (P)	M5
Operating Medium	Clean, Dry Compressed Air – 120 psig max
Mounting Positions	Unlimited
Color	Gold/Bronze Anodize

Dimensions

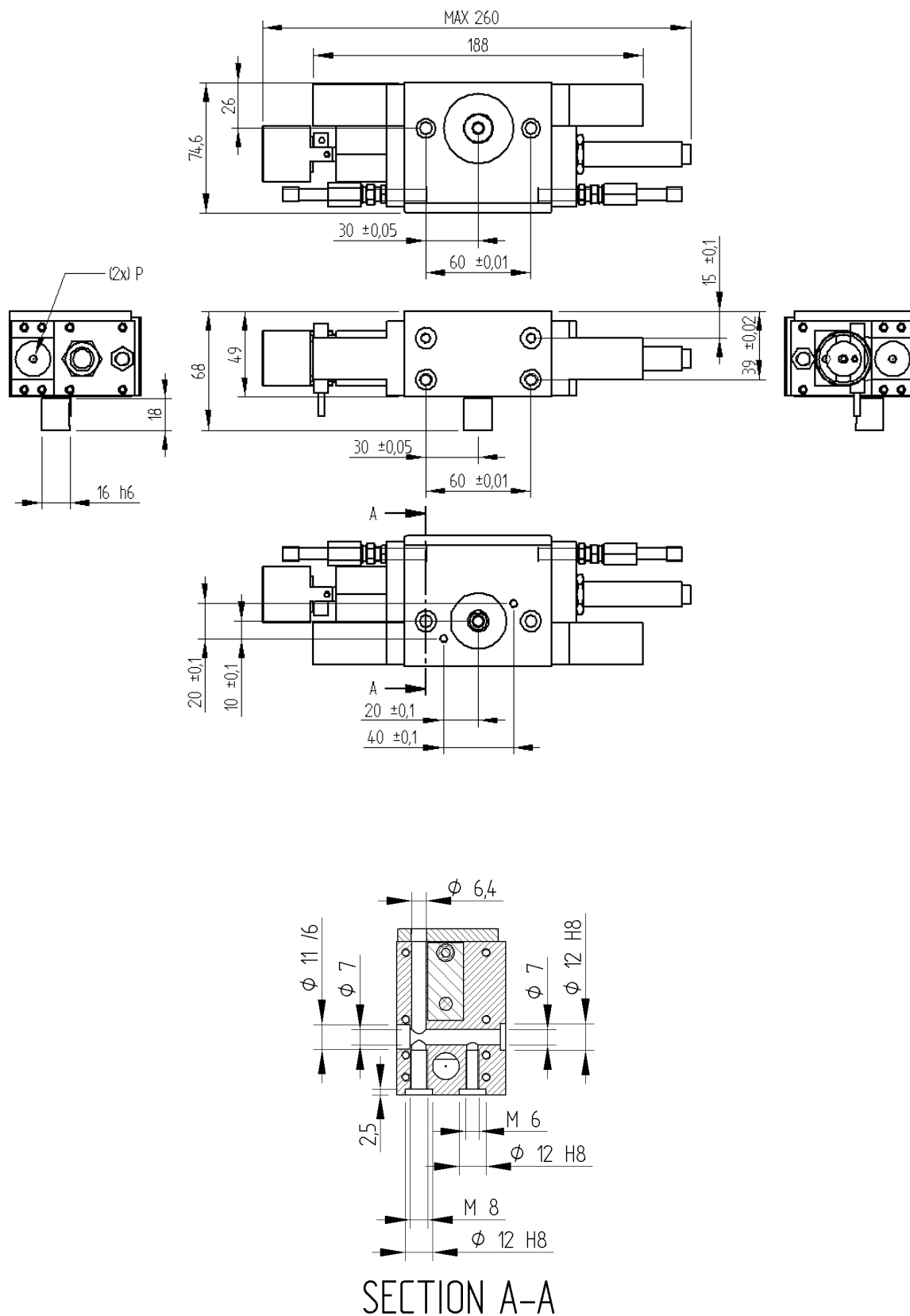

Rotary Module LR 2180 Z

With 2 Intermediate Stops

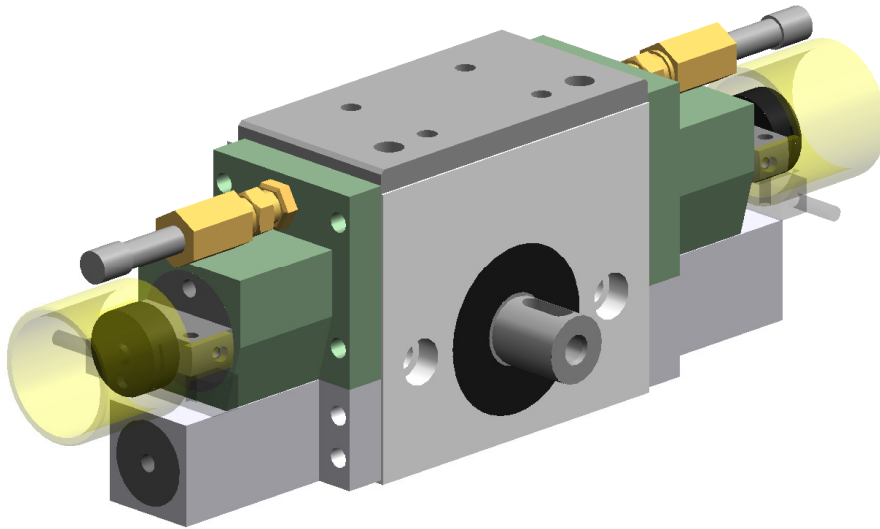

If your material handling needs call for rotary motion, look no further than the Lanco rotary module LR.

The LR series is engineered for complete compatibility with all Lanco handling system modules using the standard 60 mm (2.36 in) bolt pattern with counterbore for the exclusive Lanco locating ring.

Infinitely adjustable standard rotation ranges from zero to 185 degrees.

Design flexibility is further enhanced with optional intermediate stops, giving up to four stopping positions (2 clockwise, 2 counter clockwise) between zero and 90 degrees and 180 and 90 degrees.

The optional mounting flange offers further compatibility with handling system modules with its standard 60 mm bolt pattern.

Precision ball bearings and end-of-stroke hydraulic shock absorbers insure smooth motion. Reliability and durability is guaranteed through the use of quality components and precision CNC machining on all Lanco handling system modules.

Handling System	
Model	LR 2180 Z
Art.-No.	31-0052
Maximum Angular Rotation	0 ... 185°
Weight	1.6 kg (3.5 lbs)
Maximum Load	10 kg (22.0 lbs)
Force @ 6 bar (90 psig)	1.6 Nm (1.2 ft-lbs)
Repeatability	± 5'
Ports (P)	M5
Operating Medium	Clean, Dry Compressed Air – 120 psig max
Mounting Positions	Unlimited
Color	Gold/Bronze Anodize

Dimensions

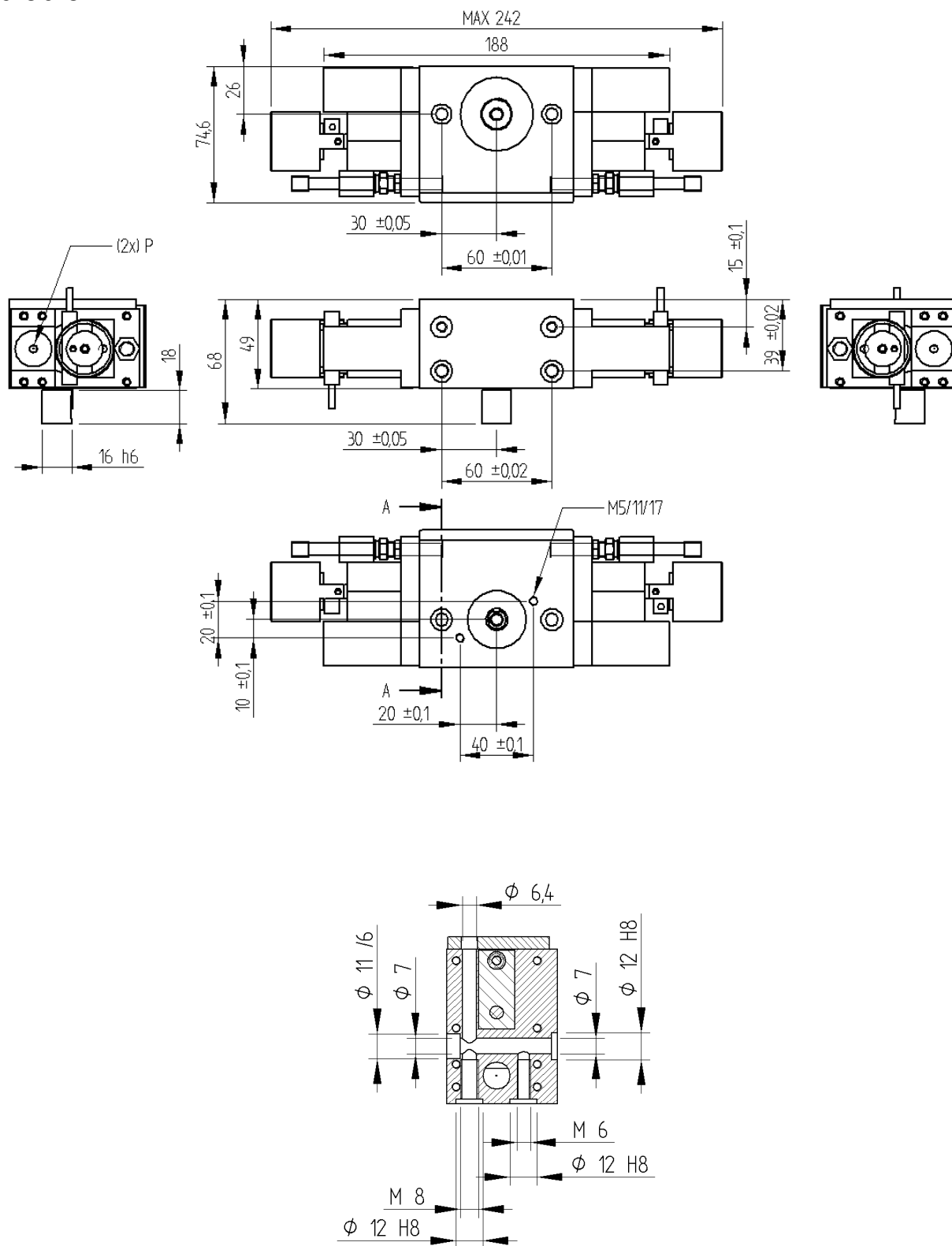

SECTION A-A